



Jenna J. Slabaugh
Paralegal

303-858-1800
jslabaugh@wbapc.com

June 12, 2024

**VIA ELECTRONIC SUBMISSION
AND ELECTRONIC MAIL**

Division of Local Government

Weld County Clerk & Recorder
crstaff@weld.gov

Weld County Assessor
assessor@weldgov.com

**Re: Prairie Song Metropolitan District No. 1 (LGID#: 66121)
Map Filing Pursuant to §32-1-306, C.R.S. – No Change in Boundaries**

To Whom It May Concern:

Section 32-1-306, C.R.S., requires special districts to provide a current, accurate map of their boundaries to the Division of Local Government, County Clerk and Recorder and County Assessor by January 1 of each year. This letter is to inform you that the map that is currently on file with your office for the above-referenced District is the most current and accurate map. A copy of the current map is attached for your convenience.

Should you have any questions, please do not hesitate to contact me.

Sincerely,

WHITE BEAR ANKELE TANAKA & WALDRON
Attorneys at Law

Jenna J. Slabaugh
Paralegal

Attachment

EXHIBIT

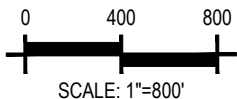

LEGEND

- ◆ ALIQUOT CORNER (AS DESCRIBED)
- METRO DISTRICT
- - - PLSS ALIQUOT LINE
- ALL LINEAL UNITS ARE US SURVEY FEET

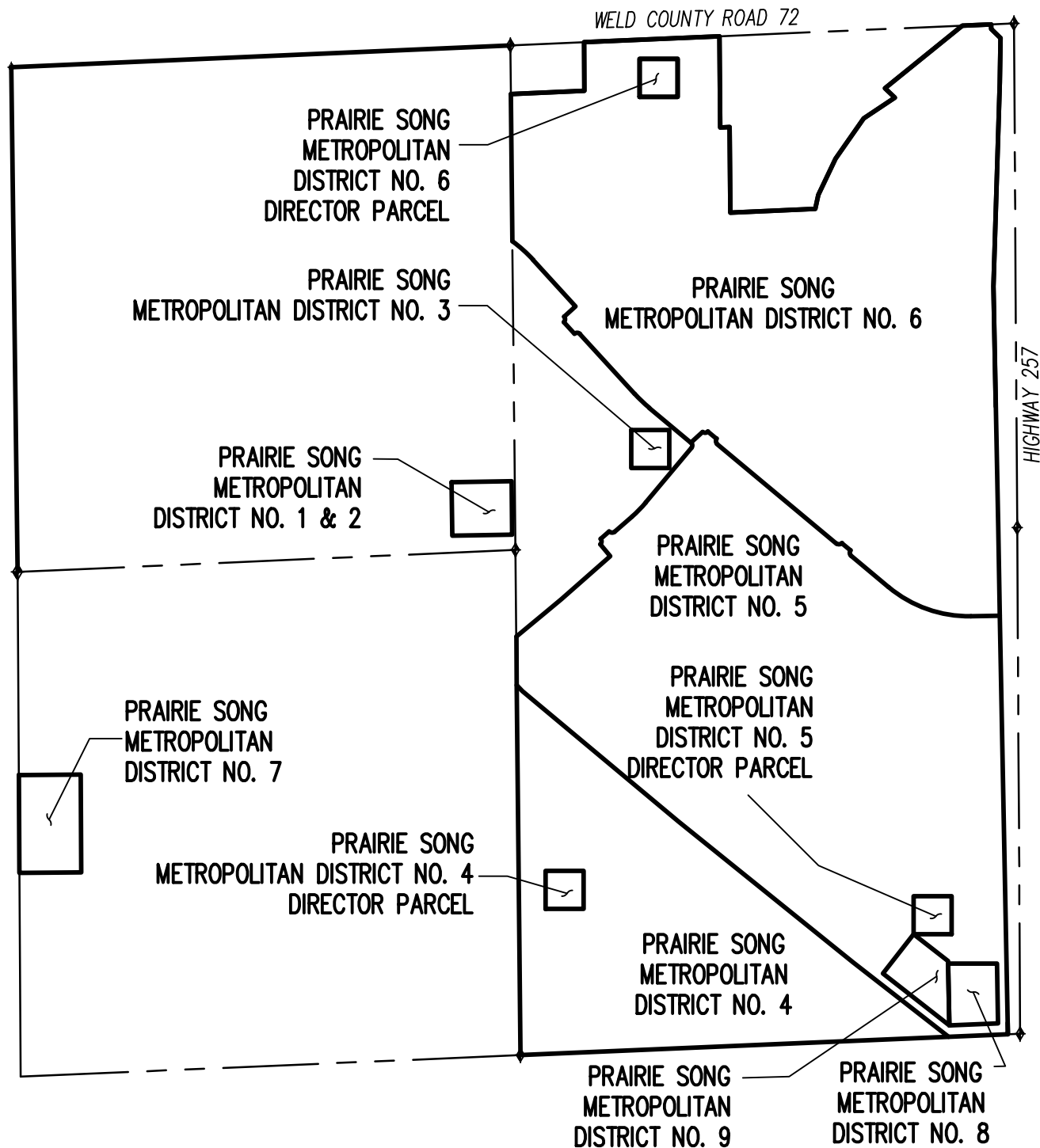

Project No:	HFH000021.10
Drawn By:	AN
Checked By:	RCR
Date:	10/11/2021 REV. 12-08-2021



5265 Ronald Reagan Blvd., Suite 210
 Johnstown, CO 80534
 970.800.3300 • GallowayUS.com



Jenna J. Slabaugh
Paralegal

303-858-1800
jslabaugh@wbapc.com

June 12, 2024

**VIA ELECTRONIC SUBMISSION
AND ELECTRONIC MAIL**

Division of Local Government

Weld County Clerk & Recorder
crstaff@weld.gov

Weld County Assessor
assessor@weldgov.com

**Re: Prairie Song Metropolitan District No. 2 (LGID#: 66122)
Map Filing Pursuant to §32-1-306, C.R.S. – No Change in Boundaries**

To Whom It May Concern:

Section 32-1-306, C.R.S., requires special districts to provide a current, accurate map of their boundaries to the Division of Local Government, County Clerk and Recorder and County Assessor by January 1 of each year. This letter is to inform you that the map that is currently on file with your office for the above-referenced District is the most current and accurate map. A copy of the current map is attached for your convenience.

Should you have any questions, please do not hesitate to contact me.

Sincerely,

WHITE BEAR ANKELE TANAKA & WALDRON
Attorneys at Law

Jenna J. Slabaugh
Paralegal

Attachment

EXHIBIT

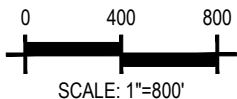

LEGEND

- ◆ ALIQUOT CORNER (AS DESCRIBED)
- METRO DISTRICT
- - - PLSS ALIQUOT LINE
- ALL LINEAL UNITS ARE US SURVEY FEET

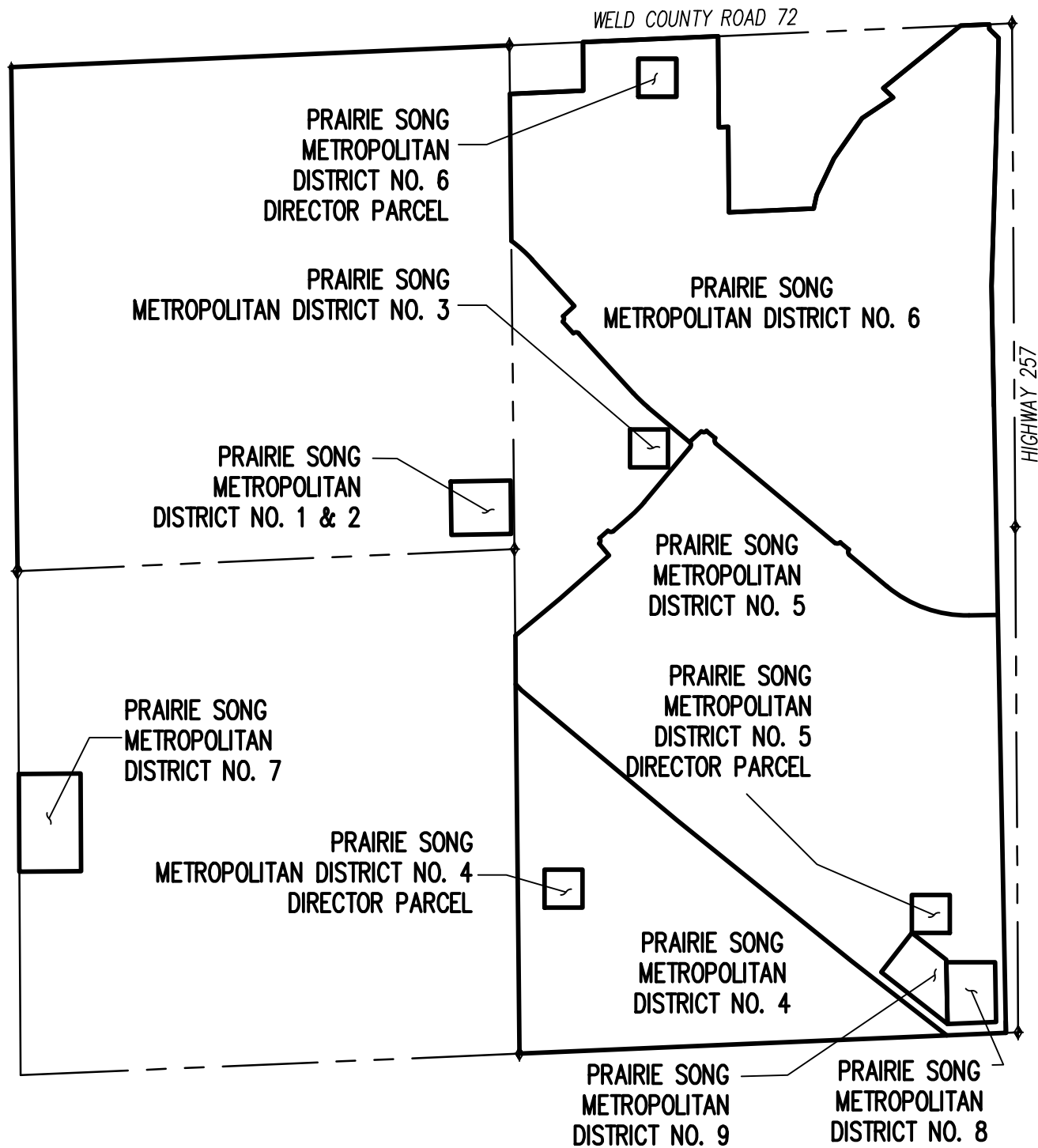

Project No:	HFH000021.10
Drawn By:	AN
Checked By:	RCR
Date:	10/11/2021 REV. 12-08-2021



5265 Ronald Reagan Blvd., Suite 210
 Johnstown, CO 80534
 970.800.3300 • GallowayUS.com



Jenna J. Slabaugh
Paralegal

303-858-1800
jslabaugh@wbapc.com

June 12, 2024

**VIA ELECTRONIC SUBMISSION
AND ELECTRONIC MAIL**

Division of Local Government

Weld County Clerk & Recorder
crstaff@weld.gov

Weld County Assessor
assessor@weldgov.com

**Re: Prairie Song Metropolitan District No. 7 (LGID#: 66523)
Map Filing Pursuant to §32-1-306, C.R.S. – No Change in Boundaries**

To Whom It May Concern:

Section 32-1-306, C.R.S., requires special districts to provide a current, accurate map of their boundaries to the Division of Local Government, County Clerk and Recorder and County Assessor by January 1 of each year. This letter is to inform you that the map that is currently on file with your office for the above-referenced District is the most current and accurate map. A copy of the current map is attached for your convenience.

Should you have any questions, please do not hesitate to contact me.

Sincerely,

WHITE BEAR ANKELE TANAKA & WALDRON
Attorneys at Law

Jenna J. Slabaugh
Paralegal

Attachment

EXHIBIT

LEGEND

◆ ALIQUOT CORNER (AS DESCRIBED)

— METRO DISTRICT

- - - PLSS ALIQUOT LINE

ALL LINEAL UNITS ARE US SURVEY FEET

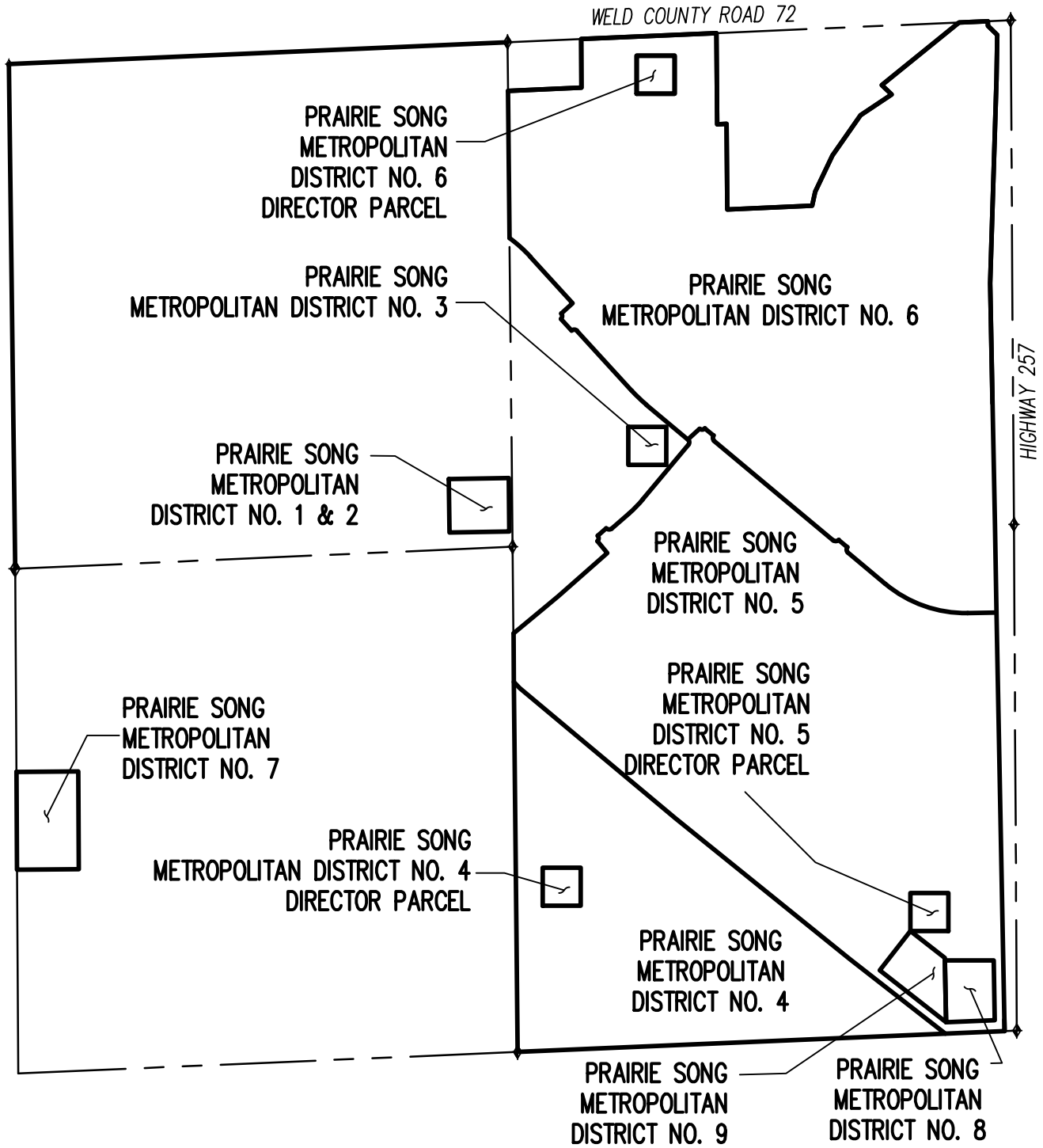
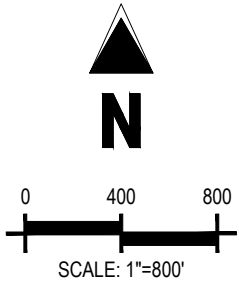

Project No: HFH000021.10

Drawn By: AN

Checked By: RCR

Date: 10/11/2021 REV. 12-08-2021

Galloway

5265 Ronald Reagan Blvd., Suite 210
Johnstown, CO 80534
970.800.3300 • GallowayUS.com